

V2.0 WIFI installation manual

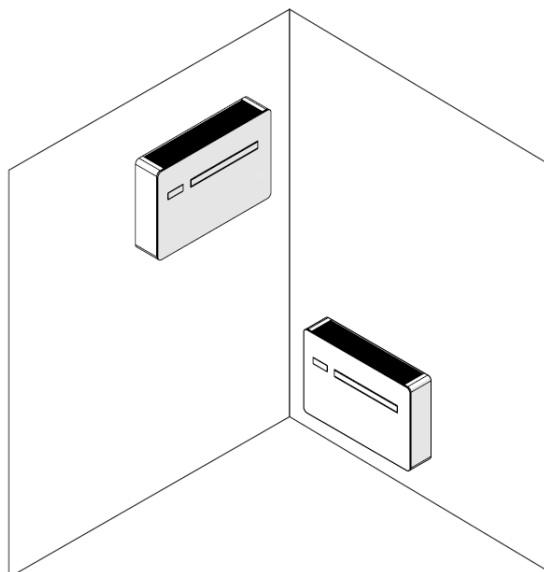

Table of contents

General information	1
General warnings	2
Components	2
Installation	4
Preparation of condensate drain	14
Electrical connection	18
Touchpad and remote control	20
Maintenance	21
Dimensions	22



The unit contains **R32** refrigerant, which is **flammable and odorless**. No ignition sources near the unit! No interference with the refrigeration circuit!

General information

Read the manual carefully before installation — follow the manual's instructions for correct and safe operation!

Safety:

- The unit contains **R32 refrigerant**, which is **flammable** and odorless. No ignition sources near the unit!
- Installation and handling of the unit may result in serious personal injury as well as extensive damage to the unit and/or the environment if not carried out in accordance with applicable safety regulations..



General Warnings

- The unit contains **R32 refrigerant**, which is **flammable** and odorless. No ignition sources near the unit!
- Read the specific warnings in each chapter before starting the installation.
- All personnel involved must be aware of the necessary safety precautions during installation.
- Any installation that disregards the warnings in this manual, or operation of the unit outside the specified temperature limits, will void the warranty.
- Any modification or tampering with the unit is strictly prohibited, as it may cause danger. The warranty will be voided.
- In the event of a liquid or oil leak, switch off the main power supply (set it to 'OFF') and immediately contact professionally qualified personnel.
- Use only original spare parts when replacing components.
- Do not use any tools or methods to accelerate the defrosting process. Allow the ice to melt over at least 6 hours with the unit turned off.
- The use of a halogen leak detector is strictly prohibited!
- The package must be transported in an upright position.
- The unit must ALWAYS be turned off and set to the "OFF" position when any work is performed on it.
- Use only original Aircold ventilation grilles. Non-original ventilation grilles will void the warranty.
- Contact Aircold at www.aircold.dk for a service agreement and ongoing maintenance of the unit.

Identification:

- **The unit can be identified by its nameplate located on the machine.**

Components

1. Control Panel	6. External air intake	11. Terminal block	16. Condensation pump	21. 4-way valve
2. Air outlet deflector	7. External air expulsion	12. Air filter	17. External exchanger	22. Compressor
3. Front panel	8. Condensate drain	13. Room air probe	18. Max. Level float	23. External air probe
4. Intake grille	9. Anti-lifting bracket	14. Internal exchanger	19. Level float	
5. Side panel	10. Remote control	15. External fan	20. Drain valve	

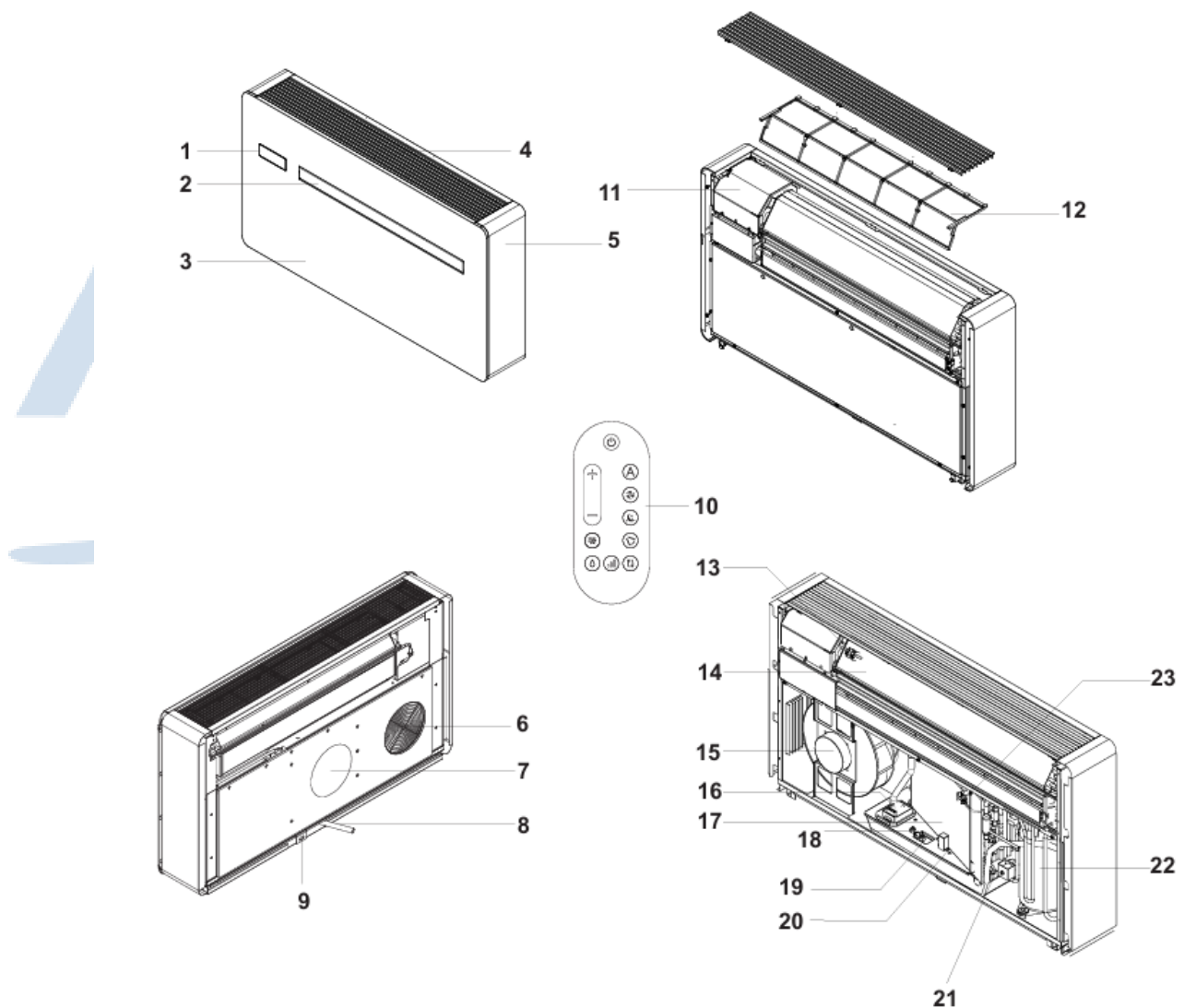

Unpacking the unit:

The unit should be unpacked carefully. Wear gloves. Use a blanket or soft surface as padding if it is temporarily placed on the floor.

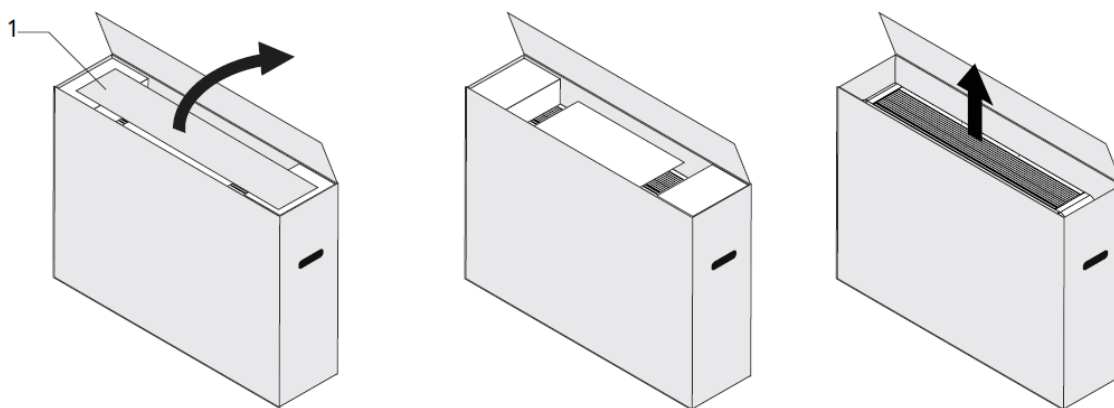

Installation

Warnings:

- DO NOT install the unit above heat sources.
- The unit must be mounted against a wall with access to the outside, or toward a room where the heat from the unit can be released without causing discomfort.
- The unit must be installed in a way that allows for servicing and maintenance.
- There must be no ignition sources near the unit. The unit contains R32 flammable refrigerant.
- The unit must under no circumstances be modified, and it is STRICTLY prohibited to open or puncture the refrigeration circuit.
- If in doubt, order professional installation at www.aircold.dk

Installation package :

A: External fixed grid for air inlet and outlet	B: Screws and plugs kit (6 pcs)	C: Bracket for wall mounting	D: User manual	E: Remote control
F: Paper template for holes	G: Remote control battery	H: Wall inlet pipes (2 pcs)	I) Energy efficiency label	J) QR code
K: External fixed grid for air inlet and outlet (rear view)	L: Drain pipe with self-regulating heating element	M: Aluminium grilles (2pcs)	N): Grounding plug	

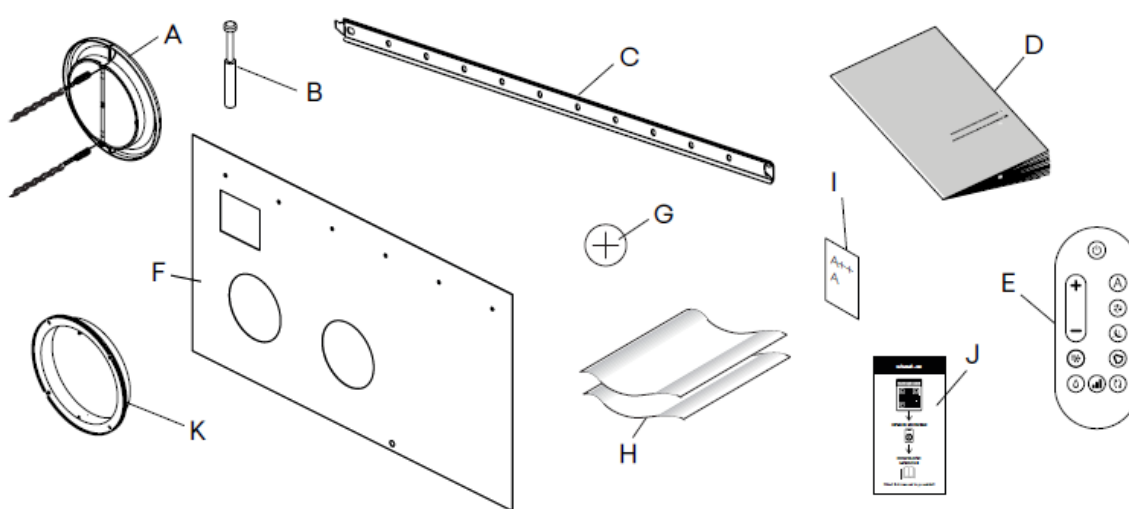

Note! For certain versions, 2 aluminium grilles are included for installation in the exterior wall.

L : Drain pipe with self-regulating heating element



M: Aluminium grilles (2pcs)



N: Grounding plug



Installation clearances and positioning:

The required clearances for installation and maintenance of the unit are shown in the diagram. The specified distances are necessary to prevent airflow obstruction and to ensure optimal cleaning and servicing.

A) High installation

B) Low installation

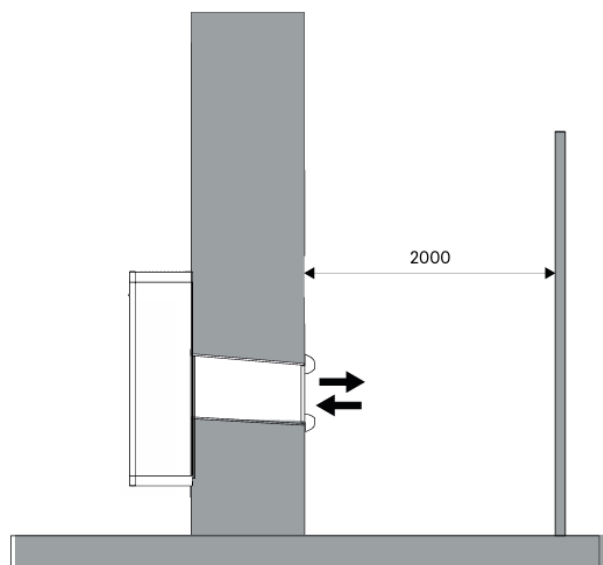
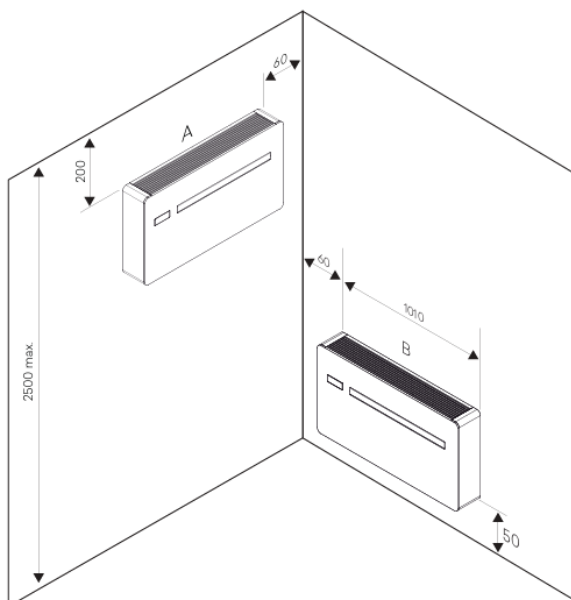

IMPORTANT!

Placement: The unit must **NOT** be installed above boxes or shelves that could be damaged by possible drain or defrost water overflow. Aircold provides no warranty or compensation for consequential damages!

Note! The air intake and outlet must remain completely unobstructed and must not be blocked in any way. This applies to both the indoor air openings inside the room and the exterior wall grilles.

Mounting template:

The unit is supplied with a mounting template for marking holes, the mounting rail, and the fixing bracket.

The holes are required for installation.

A) Holes for M8 plugs	B) Electrical connection area	C) Ø202 mm holes for air channelling
D) Ø18 mm condensation drain	E) Anti-lifting bracket hole Ø8 mm	

A mounting template is included with the unit. It is used for marking holes and related mounting points.

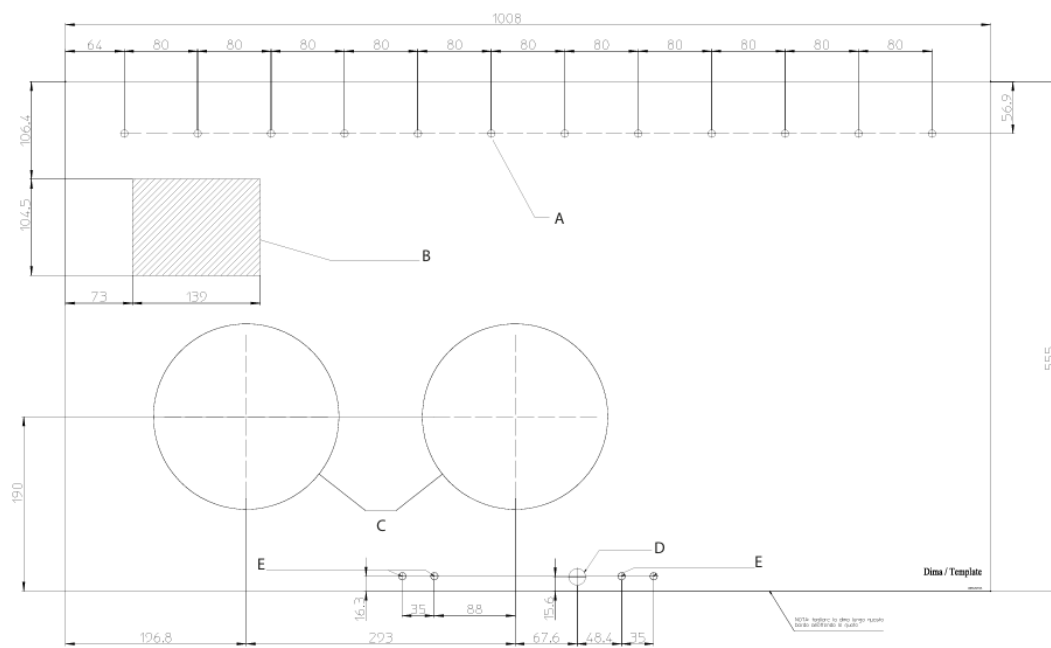

Wall drilling for ducts:

A: Inside wall	B: Outside wall	1: Outer wall
2: Unit	3: Air inlet and outlet grilles	4: Air ducts (plastic panels)

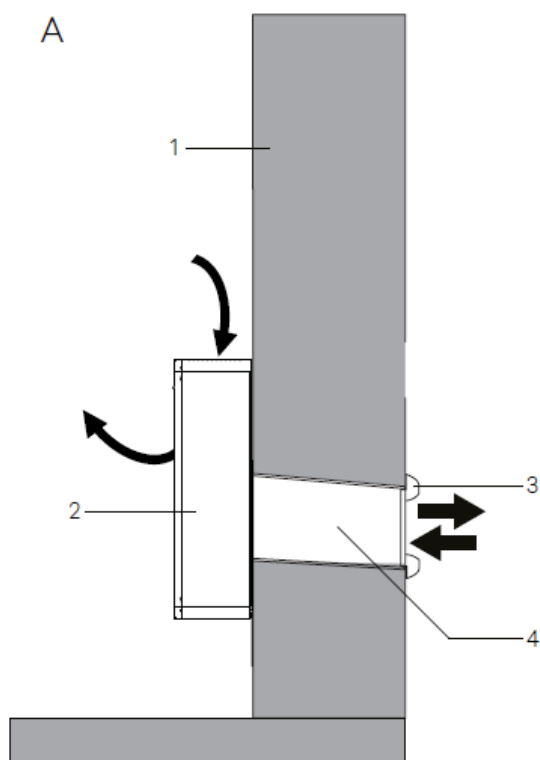

old

Note! Observe the specified distances in the chapter “Installation clearances and positioning.”

Position the mounting template level at the desired location and secure it with tape.

- Mark the hole positions – check for any electrical wiring in the wall!
- Use a power drill.
- Drill a pilot hole.
- Use a core drill/hole saw.
- Drill through the wall.
- Maintain a slight downward angle of approximately 3–5% toward the outside.

The hole must not exceed a depth of 1 meter.

Note! Bends are strictly prohibited! Only straight pipes with a diameter of Ø160 or larger may be used, with no bends allowed!

Note! Drilling holes in heavy walls such as brick or concrete should be carried out by a professional drilling company.

Mounting wall ducts / plastic conduits:

A) Plastic panels for wall ducts

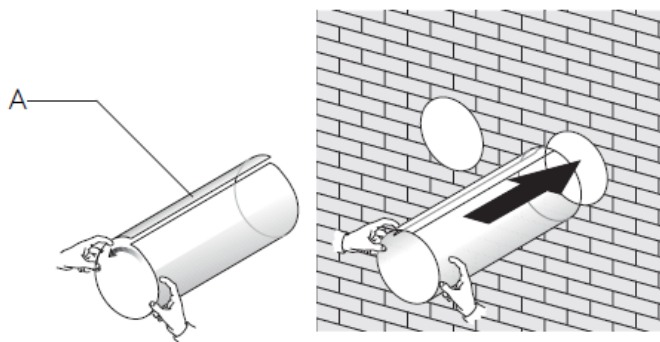

- Measure the depth of the wall holes.
- Subtract 5 mm from the measurement.
- Cut the supplied plastic panels to size.
- Roll the clear plastic panels to form two tubes.
- Insert one rolled plastic tube into each of the two holes.
- Position the plastic tubes so that the edges of the panels are recessed approximately 2 mm from both ends of the hole.

Mounting of ventilation grilles on the exterior wall:

Note! Only **original** ventilation grilles from Aircold may be used; otherwise, the warranty will be void.

Note! Aluminium ventilation grilles with insect/pest protection nets are available as an alternative to the plastic grilles. **Contact Aircold** for more information.

Before installing the supplied standard grilles, it is important to distinguish between the air intake grille and the air discharge grille.

OUT The discharge grille is labeled **AIR DELIVERY DAMPER**.

IN The intake grille is labeled **AIR INTAKE DAMPER**.

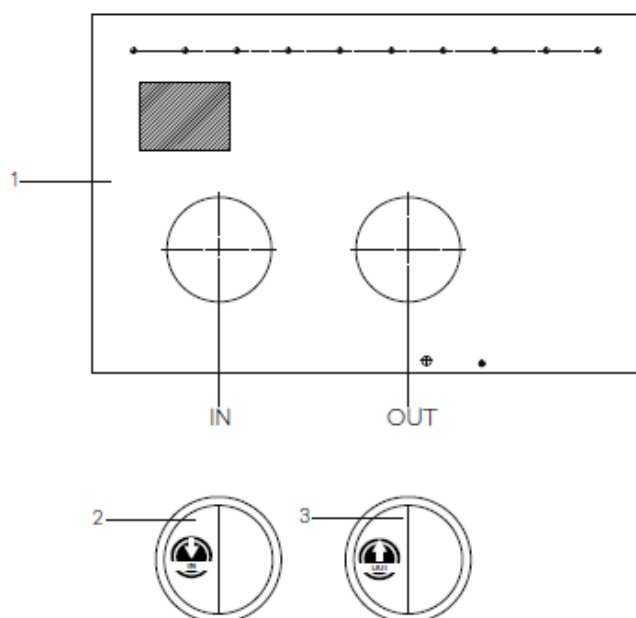

IN = Air intake

OUT = Air discharge

1) Chain	2) Counter flange
3) Spring	4) External ventilation grille

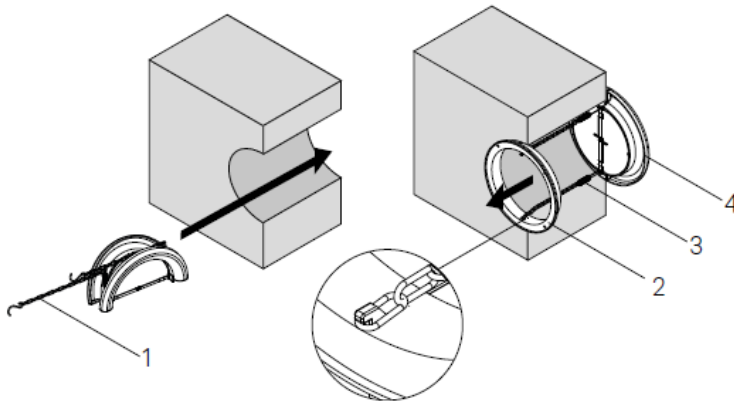

Fold the damper/ventilation grille.

- Insert it into the duct until it comes out on the opposite side of the wall.
- Hold the chains with your other hand to prevent the ventilation grille from falling.
- Open the ventilation grille outside the hole.
- Rotate the grille so that the flaps are positioned vertically.
- Insert the counter flange into the hole on the room's interior side.
- Rotate it so that the hooks are positioned vertically.
- Pull the chains to tension the springs.
- Attach the chains to the counter flange.
- Cut off any excess chain.

Use only the ventilation grilles supplied with the unit. Otherwise, the warranty will be void!

For alternative ventilation grille options, please contact Aircold.

Note! Certain versions include two aluminium ventilation grilles for exterior wall installation.

Mounting the wall bracket / mounting rail:

1: Spirit level	2: Mounting rail	3: Mounting screw	4: Wall	5: Rawlplug
-----------------	------------------	-------------------	---------	-------------

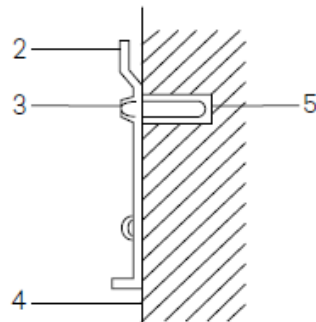
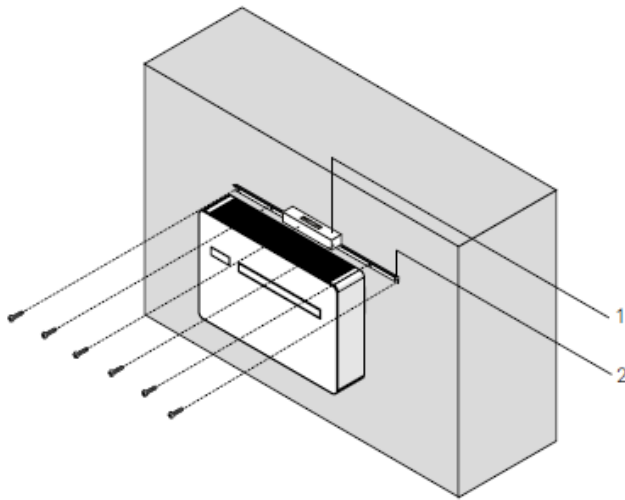

- Use the mounting template
- Mark the hole positions on the wall
- Use a power drill
- Drill holes at the marked positions
- Secure the mounting rail with screws and plugs.

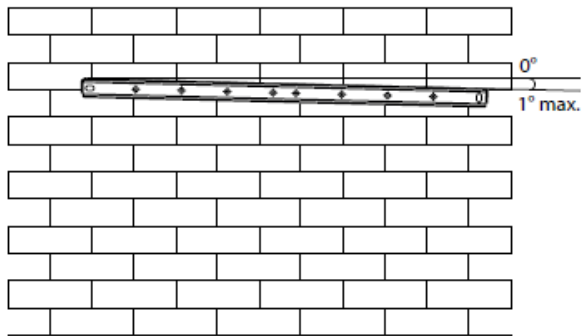

CHECK WITH A SPIRIT LEVEL THAT THE INSTALLATION IS HORIZONTAL!

A maximum tilt of 1° is allowed

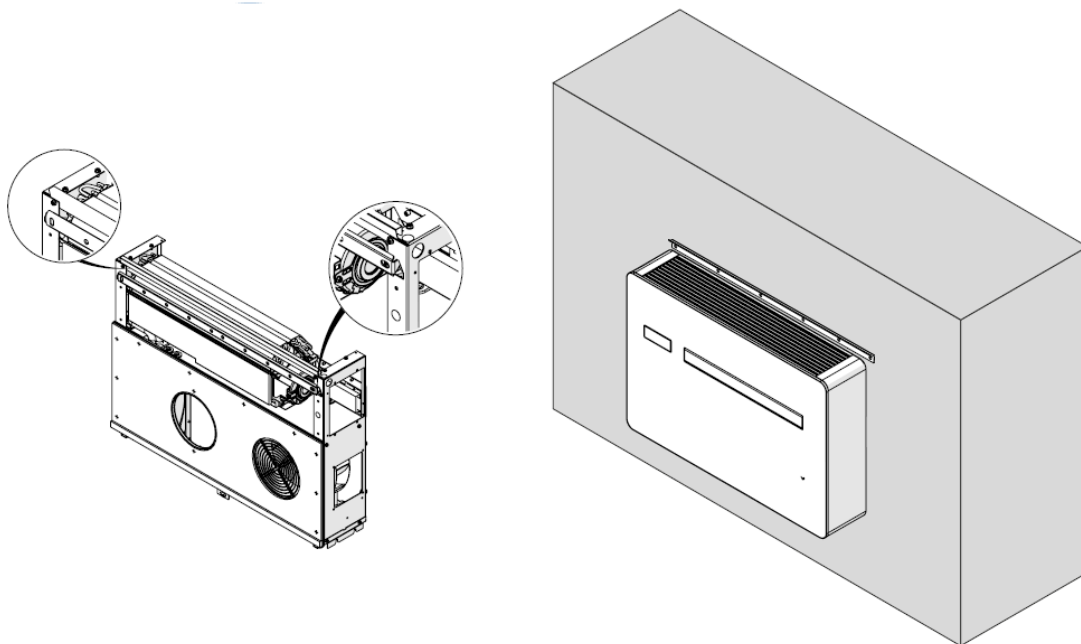

- Attach the unit to the upper part of the mounting rail.
- A fixing bracket is located at the bottom of the unit. Use this bracket if necessary to secure the unit to the wall

Preparation of condensate drain

1. Condensate drain
2. Drain plug

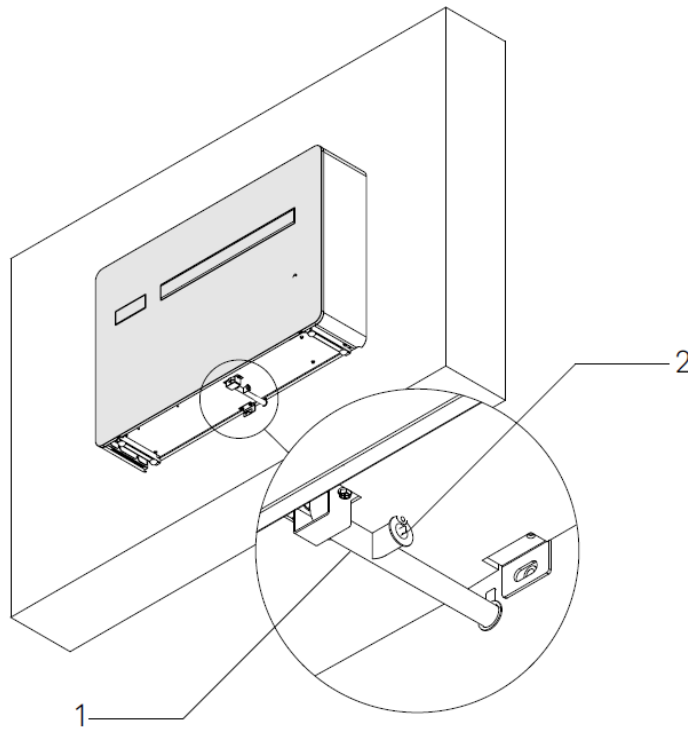

- The drain line must maintain a 3% downward slope toward the outside to ensure proper condensate drainage.

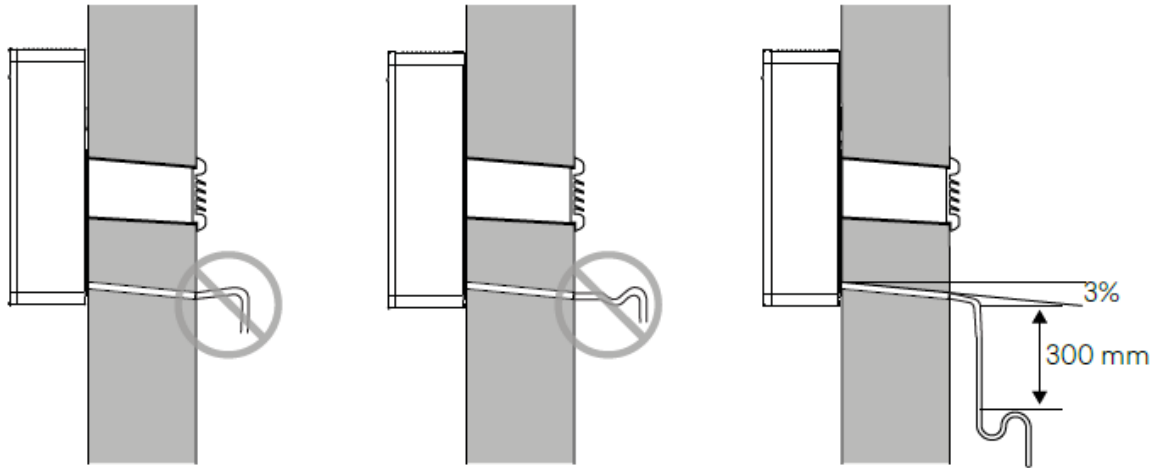

- If the drain discharges directly outside without a connected drain pipe, the water will run down the wall and freeze when the outdoor temperature reaches freezing point.

If using a bucket for condensate collection:

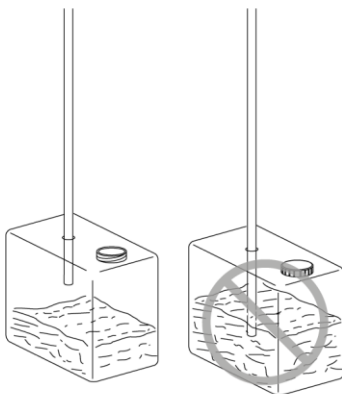

Installation of drain hose with self-regulating electric heating element:

The unit is supplied with a kit containing a drain hose with a self-regulating electric heating element. This kit should be installed to ensure that the drain does not freeze during winter. Installation is explained in the following image series:

1. The bottom of the unit shown with a standard drain hose without a self-regulating heating element:



- 2: Remove the standard drain hose and the metal cover:



3: Install the drain hose with heating element. Insert the plug and reinstall the metal cover as shown:



Electrical connection

The unit must be supplied from a 13A, 230V 50Hz grounded circuit.

The unit is supplied with a pre-installed power cord and plug, along with a separate grounding connector. Attach the grounding connector to the plug, then insert the plug into a grounded 230V 13A socket.

- Electronic warnings related to the unit

- Ensure the unit is turned off before accessing it.
- Under **no** circumstances should the refrigeration circuit be tampered with!
- Install a proper ground connection. A grounding plug is supplied with the unit and must be used.
- Use a dedicated power supply. Never connect other devices to the same circuit to avoid overheating, electric shock, or fire.
- Connection to the power terminals inside the electrical panel must only be performed by authorized technicians.

Access to the unit's electrical panel:

1. Intake grille	4. Connectors
2. Front panel	5. Electrical panel covering
3. Touchscreen	6. Fixing screws



Only be performed by authorized technicians.

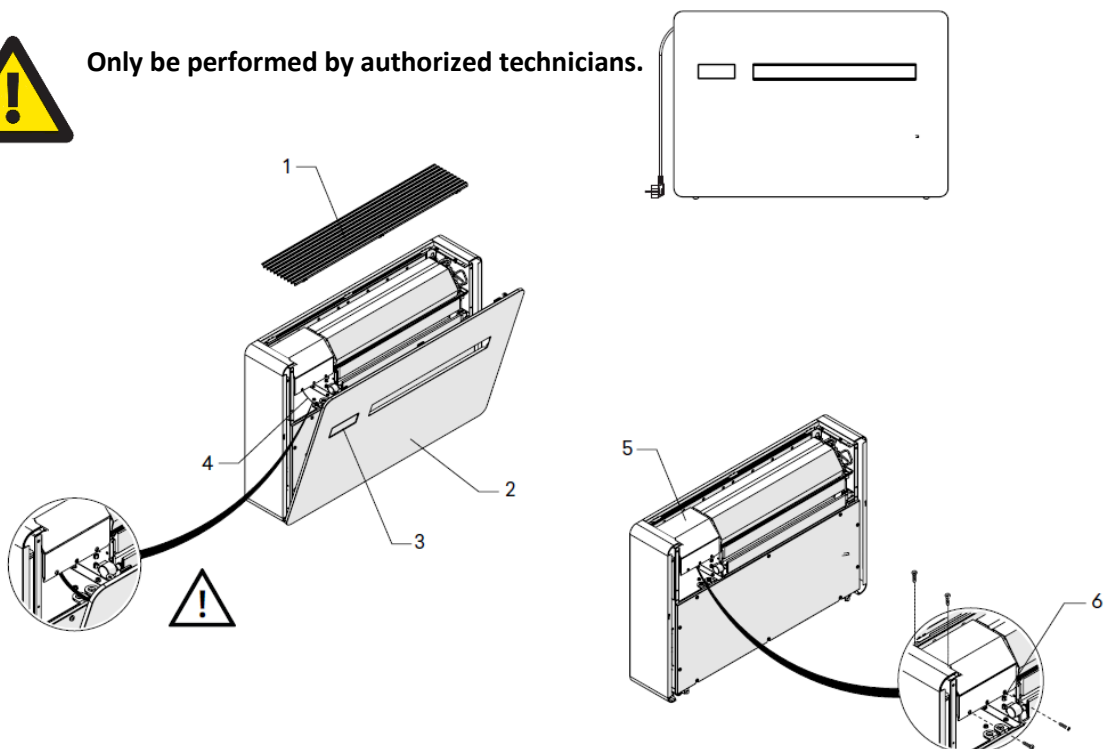

- Disconnect the power supply to the unit.
- Remove the front panel and disconnect the touchscreen control panel connection.
- Unscrew the screws securing the electrical panel.
- Remove the electrical panel cover.

PE-IN = Earth connection	B A = Serial connection
ACL-IN= Phase	CP = Presence contact (normally jumpered)
ACN-IN = Neutral	

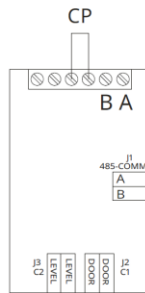
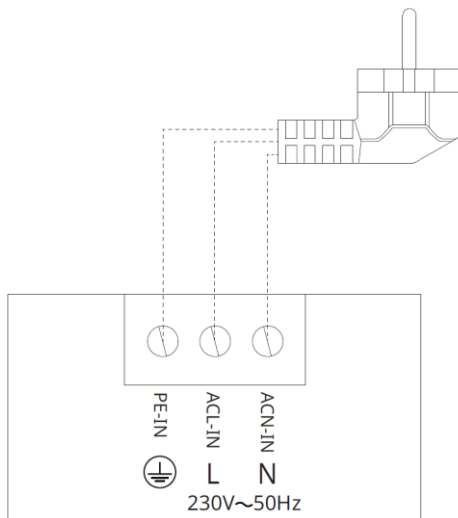

Touchpad and remote control

Touchpad:

REFER TO THE USER MANUAL FOR MORE INFORMATION!

Alarms on the display:

- In the event of an alarm, the unit will continue to operate with active functions.
- A flashing power button and an alarm code will appear on the touchscreen display to indicate the alarm.

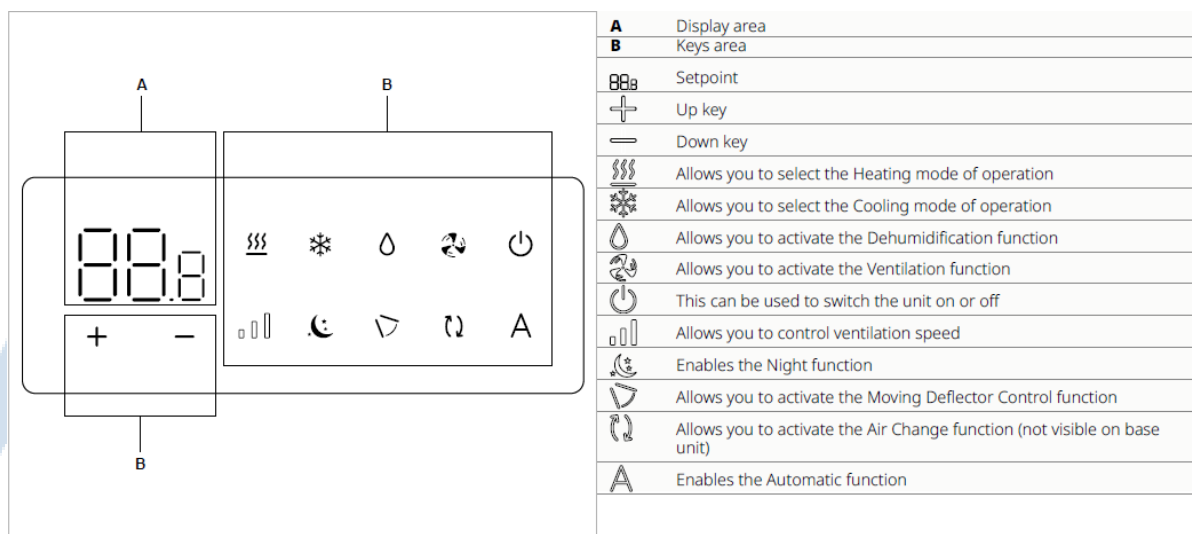

Code	Alarm description
Er01	Room temperature probe error (RT)
Er02	Error of the temperature sensor of the internal heat exchanger (IPT)
Er03	Error outdoor air temperature probe (OT)
Er04	Error of the external heat exchanger temperature probe (OPT)
Er05	Malfunctioning of the internal fan
Er06	Malfunction of the external fan
Er07	Driver communication error
Er08	Compressor discharge temperature probe (TD) error
Er09	Communication error with remote thermostat M7
Er10	Maximum level float intervention in the condensate drip tray (ALARM)
CP	Open (CP) contact
Er12	Driver error - compressor failure
CE	Communication error between main circuit board and display
Er16	4-way valve management error or alarm for insufficient refrigerant charge
Er17	Driver parameter error or compressor incompatibility
Er19	Heating element safety temperature probe error (LEVEL)
Er20	Error of the second temperature probe of the external heat exchanger (GT)
Er22	Wrong power supply
Er23	UV lamp kit error
Er24	ERV kit error
BL	Key lock

Maintenance

Clean the surfaces with a soft, damp cloth. Clean the unit at least every 6 months.

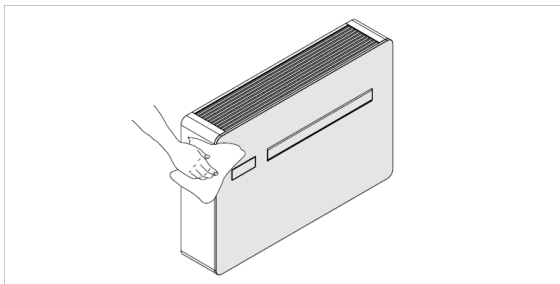

Do not use abrasive sponges, scouring agents, or corrosive cleaning products, as they may damage the painted surfaces.

Filter cleaning:

Clean the filters after a period of continuous operation and at least once per month.

- The filter is located at the top of the unit.
- Remove the filter from the unit.
- Remove dust from the filter using a vacuum cleaner, then wash it under running water.
- Allow it to dry completely.
- Reinstall the filter, ensuring it is positioned correctly.

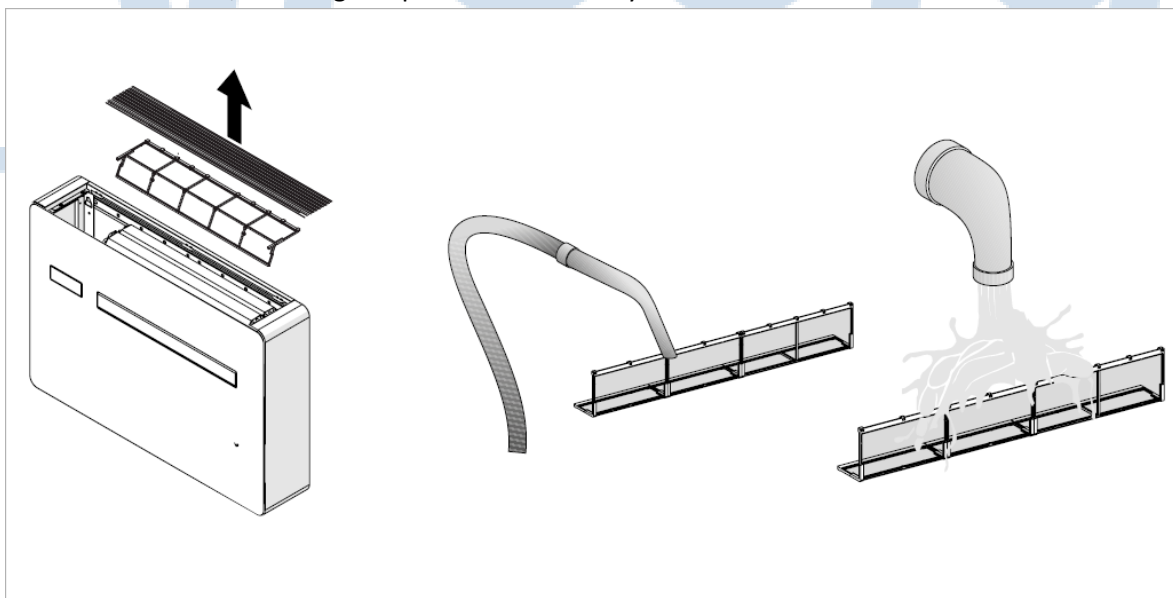

Exterior wall grilles:

Inspect the exterior wall grilles at least once a month. Ensure they are clear and free of leaves or other debris.

Dimensions

Width	mm	1010
Height	mm	549
Total depth	mm	165
Empty weight	kg	41
Wall hole diameter	mm	202
Wale holes distance	mm	293

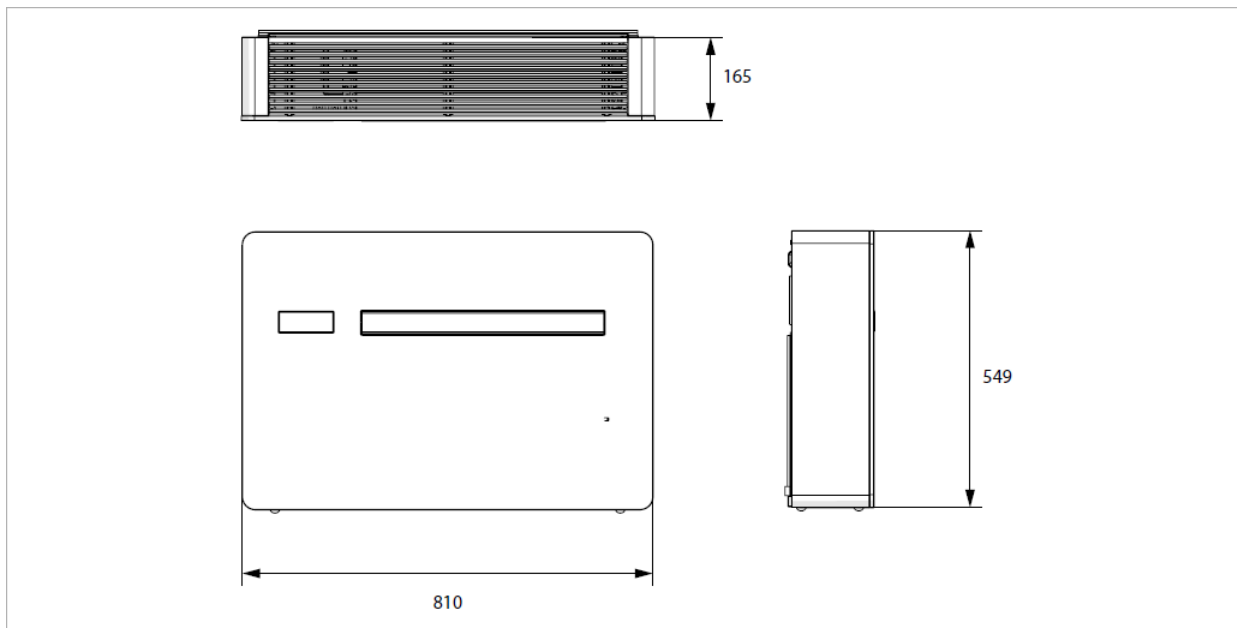

To ensure optimal performance and longevity of the unit, it is recommended to have an annual service inspection performed.

For further information on operating the unit, please refer to our user manual.

Learn more about our products on www.Aircold.dk